

Electrode for Spot Welder

Straight Shank

ストレートシャンク material(材質) : CrCu(クローム銅)

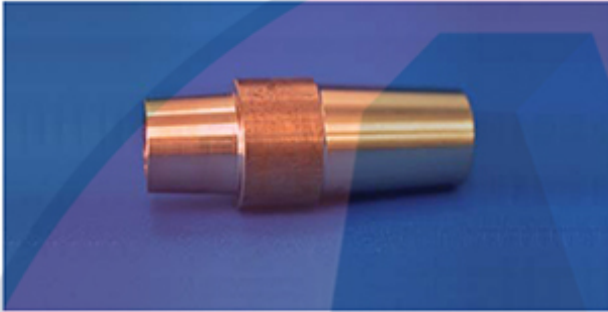

Please order with the model number below.
ご注文は下記の記号にてお願いいたします。

N-SH-22-

↑ Effective length A
有効長A

$\phi 22$ T=1/10

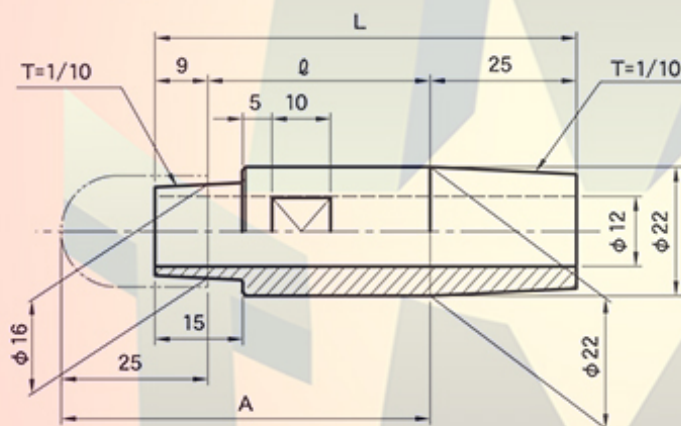

Unit(単位):mm

Model No. 型式	Effective length A 有効長A	Length L 全長L	ϕ
N-SH-22- 40	40	49	15
N-SH-22- 50	50	59	25
N-SH-22- 60	60	69	35
N-SH-22- 70	70	79	45
N-SH-22- 80	80	89	55
N-SH-22- 90	90	99	65
N-SH-22-100	100	109	75

material(材質) : CrCu(クローム銅)

Mastech Trading & Machining co.,ltd.

>>> <http://www.mastechtrading.com>

Electrode for Spot Welder

Straight Shank

ストレートシャンク (クローム銅)

$\phi 12$ T=1/10

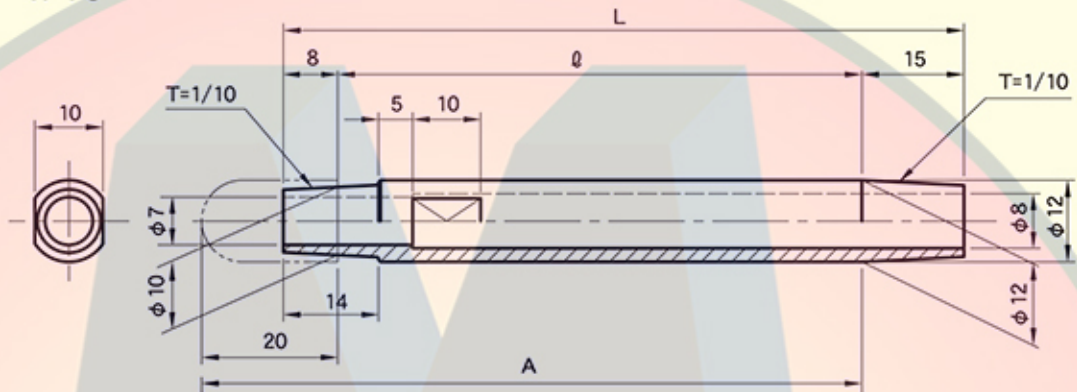

Please order with the model number below.
ご注文は下記の記号にてお願いいたします。

N-SH-12- Length L



Unit(単位):mm

Model No. 型式	L 全長	A	φ
N-SH-12-35	38	35	15
N-SH-12-40	43	40	20
N-SH-12-45	48	45	25
N-SH-12-50	53	50	30
N-SH-12-55	58	55	35
N-SH-12-60	63	60	40
N-SH-12-65	68	65	45
N-SH-12-70	73	70	50
N-SH-12-75	78	75	55
N-SH-12-80	83	80	60
N-SH-12-85	88	85	65
N-SH-12-90	93	90	70
N-SH-12-95	98	95	75
N-SH-12-100	103	100	80

material(材質): CrCu(クローム銅)

$\phi 13$ T=1/10

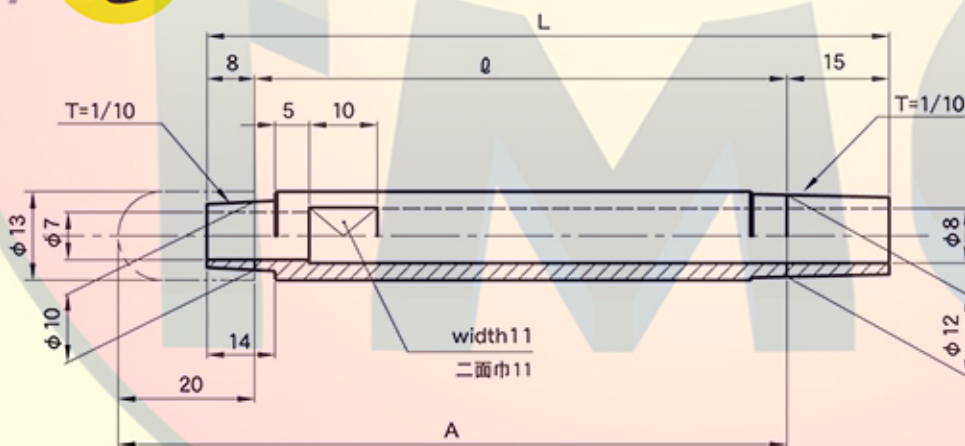

Please order with the model number below.
ご注文は下記の記号にてお願いいたします。

N-SH-13- Length L



Unit(単位):mm

Model No. 型式	L 全長	A	φ
N-SH-13-35	38	35	15
N-SH-13-40	43	40	20
N-SH-13-45	48	45	25
N-SH-13-50	53	50	30
N-SH-13-55	58	55	35
N-SH-13-60	63	60	40
N-SH-13-65	68	65	45
N-SH-13-70	73	70	50
N-SH-13-75	78	75	55
N-SH-13-80	83	80	60
N-SH-13-85	88	85	65
N-SH-13-90	93	90	70
N-SH-13-95	98	95	75
N-SH-13-100	103	100	80

material(材質): CrCu(クローム銅)

Straight Shank

ストレートシャンク

Electrode for Spot Welder

Straight Shank

ストレートシャンク (クローム銅)

$\phi 16$ T=1/10

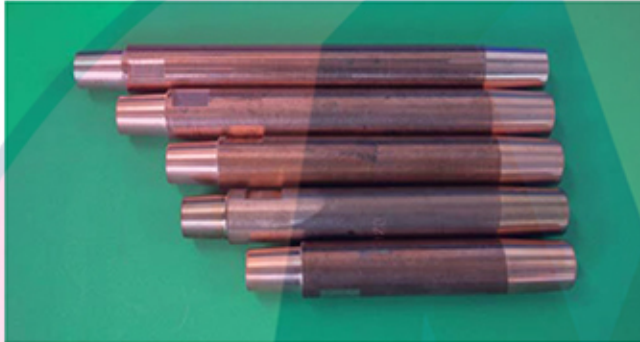

Please order with the model number below.
ご注文は下記の記号にてお願いいたします。

N-SH-16-
↑ Length L
全長 L



Unit(単位):mm

Model No. 型式	L 全長	A	ϕ
N-SH-16-35	35	31	6
N-SH-16-40	40	36	11
N-SH-16-45	45	41	16
N-SH-16-50	50	46	21
N-SH-16-55	55	51	26
N-SH-16-60	60	56	31
N-SH-16-65	65	61	36
N-SH-16-70	70	66	41
N-SH-16-75	75	71	46
N-SH-16-80	80	76	51
N-SH-16-85	85	81	56
N-SH-16-90	90	86	61
N-SH-16-95	95	91	66
N-SH-16-100	100	96	71
N-SH-16-105	105	101	76
N-SH-16-110	110	106	81
N-SH-16-115	115	111	86
N-SH-16-120	120	116	91
N-SH-16-125	125	121	96
N-SH-16-130	130	126	101
N-SH-16-135	135	131	106
N-SH-16-140	140	136	111
N-SH-16-145	145	141	116
N-SH-16-150	150	146	121
N-SH-16-155	155	151	126
N-SH-16-160	160	156	131

material(材質) : CrCu(クローム銅)

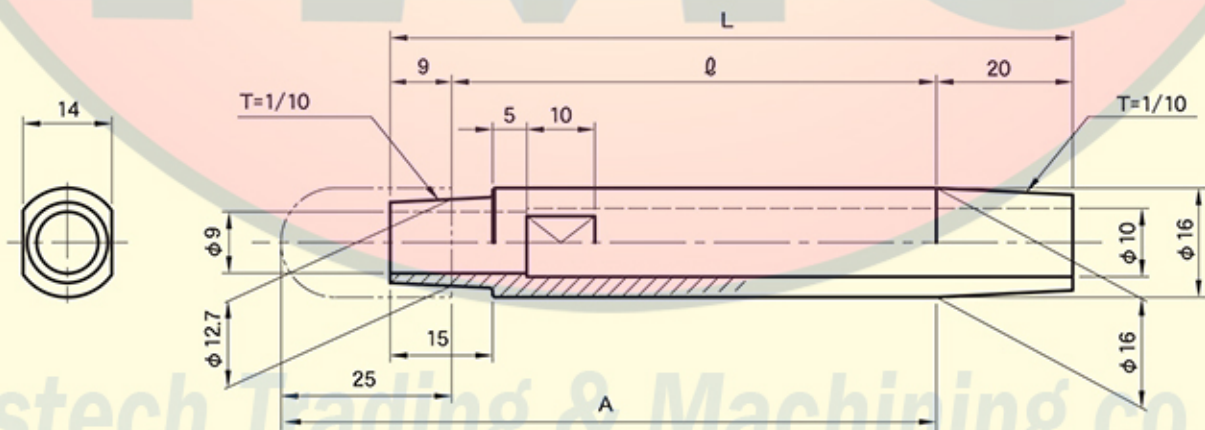

Mastech Trading & Machining Co., Ltd.

Electrode for Spot Welder

Straight Shank

ストレートシャンク (BeA-25)

$\phi 12.065$ T=MT#1

Please order with the model number below.
ご注文は下記の記号にてお願いいたします。

W-SH-13-

Effective length A
有効長A

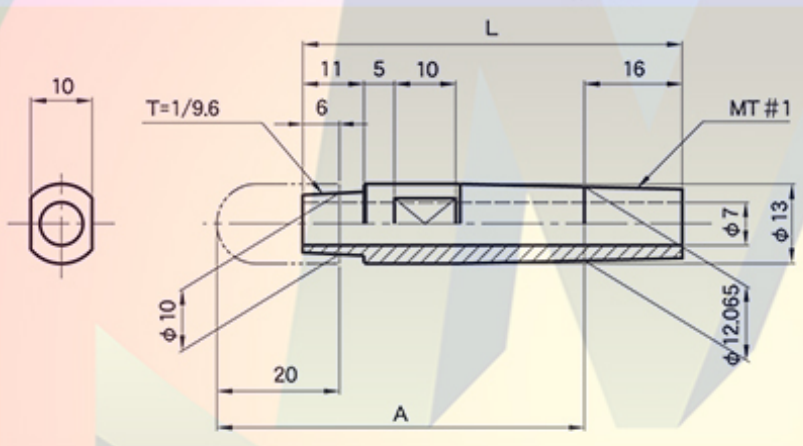
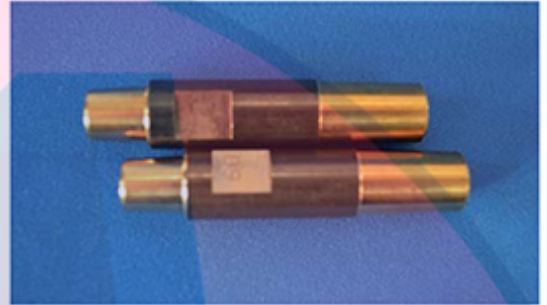

Unit(単位):mm

Model No. 型式	Effective length A 有効長	Length L 全長
W-SH-13-40	40	42
W-SH-13-50	50	52
W-SH-13-60	60	62
W-SH-13-70	70	72
W-SH-13-80	80	82
W-SH-13-90	90	92
W-SH-13-100	100	102

material(材質): BeA-25

$\phi 18.5$ T=1/10

Please order with the model number below.
ご注文は下記の記号にてお願いいたします。

W-SH-19-

Effective length A
有効長A

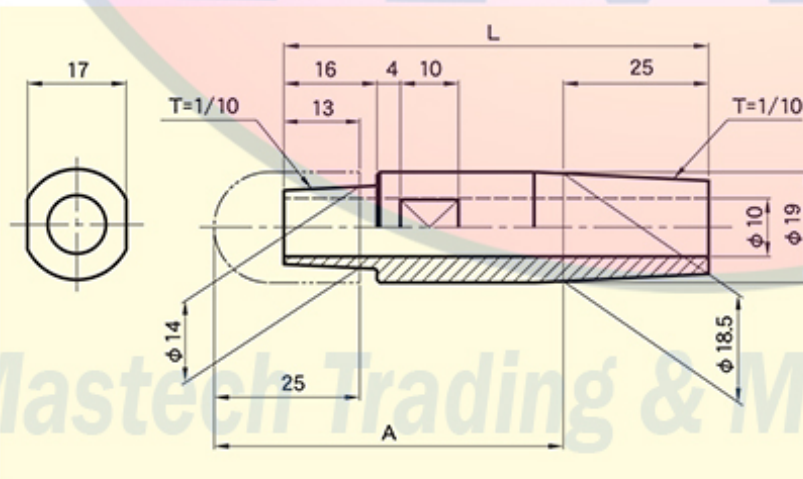
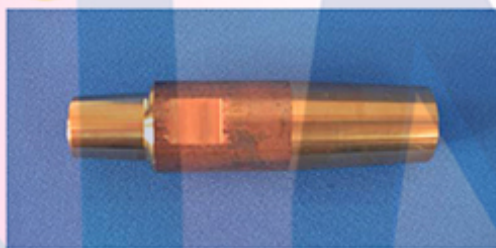

Unit(単位):mm

Model No. 型式	Effective length A 有効長	Length L 全長
W-SH-19-40	40	53
W-SH-19-50	50	63
W-SH-19-60	60	73
W-SH-19-80	80	93
W-SH-19-100	100	113
W-SH-19-120	120	133

material(材質): BeA-25

Straight Shank

ストレートシャンク

Mastech Trading & Manufacturing Ltd.

Electrode for Spot Welder

Straight Shank

ストレートシャンク (BeA-25)

$\phi 15.875$ T=MT#2

Please order with the model number below.
ご注文は下記の記号にてお願いいたします。

W-SH-16-

Effective length A
有効長A

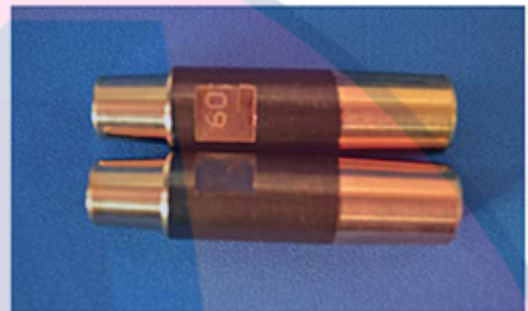

Unit(単位):mm

Model No. 型式	Effective length A 有効長	Length L 全長
W-SH-16-40	40	44
W-SH-16-50	50	54
W-SH-16-60	60	64
W-SH-16-70	70	74
W-SH-16-80	80	84
W-SH-16-90	90	94
W-SH-16-100	100	104
W-SH-16-120	120	124
W-SH-16-150	150	154

material(材質) : BeA-25

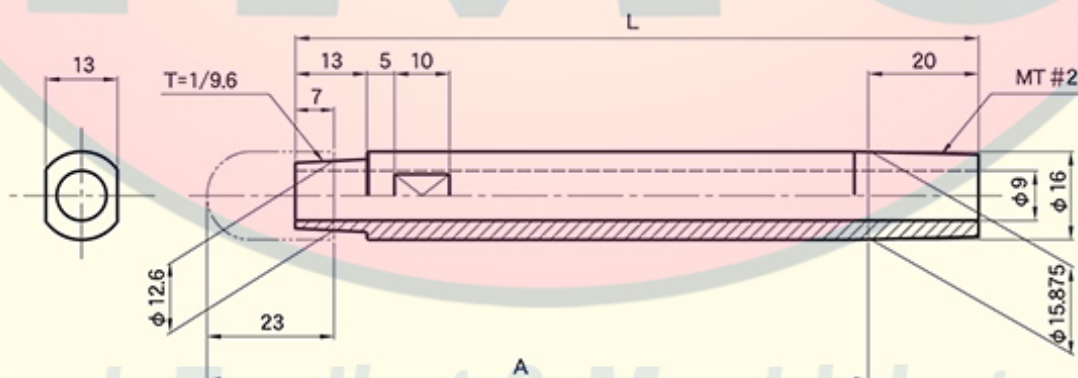

Mastech Trading & Machining co.,ltd.

Stepped Shank

段付シャンク

φ 9

T=1/10

Please order with the model number below.
ご注文は下記の記号にてお願いいたします。

Length L Taper
SDH-9-16-**-**

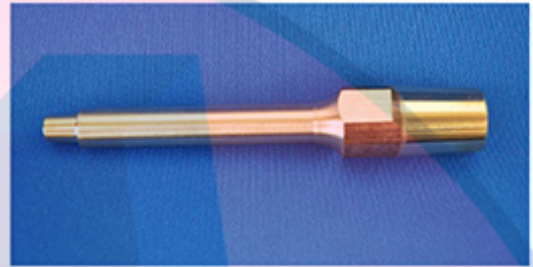

Unit(単位):mm

Model No. 型式	L 全長	Taper1 テーパ-1	Taper2 テーパ-2
SDH-9-16-45	45	φ16×1/10	φ15.875×MT#2
SDH-9-16-50	50	↑	↑
SDH-9-16-55	55	↑	↑
SDH-9-16-60	60	↑	↑
SDH-9-16-70	70	↑	↑
SDH-9-16-80	80	↑	↑
SDH-9-16-90	90	↑	↑
SDH-9-16-100	100	↑	↑

material(材質) : BeA-25

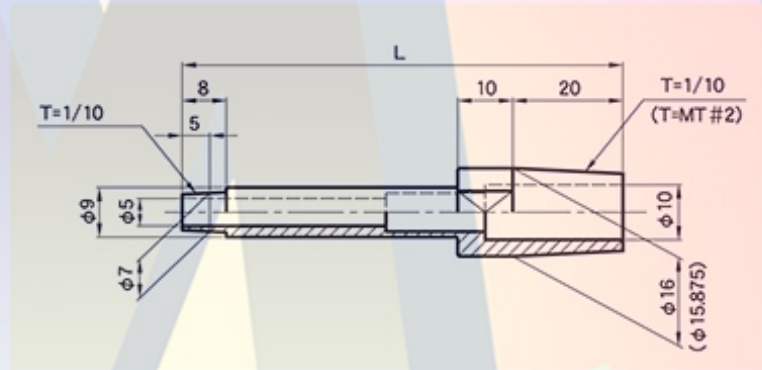

φ 13

T=1/10

Length L Taper
SDH-13-16-**-**

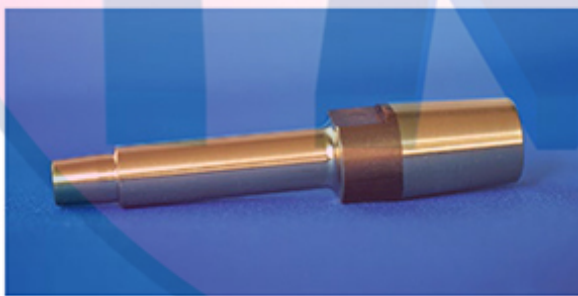

Unit(単位):mm

Model No. 型式	L 全長	A	Taper1 テーパ-1	Taper2 テーパ-2
SDH-13-16-40	40	30	φ16×1/10	φ15.875×MT#2
SDH-13-16-46	46	40	↑	↑
SDH-13-16-56	56	50	↑	↑
SDH-13-16-66	66	60	↑	↑
SDH-13-16-76	76	70	↑	↑
SDH-13-16-86	86	80	↑	↑
SDH-13-16-96	96	90	↑	↑
SDH-13-16-106	106	100	↑	↑
SDH-13-16-116	116	110	↑	↑
SDH-13-16-126	126	120	↑	↑
SDH-13-16-136	136	130	↑	↑
SDH-13-16-146	146	140	↑	↑
SDH-13-16-156	156	150	↑	↑

material(材質) : BeA-25

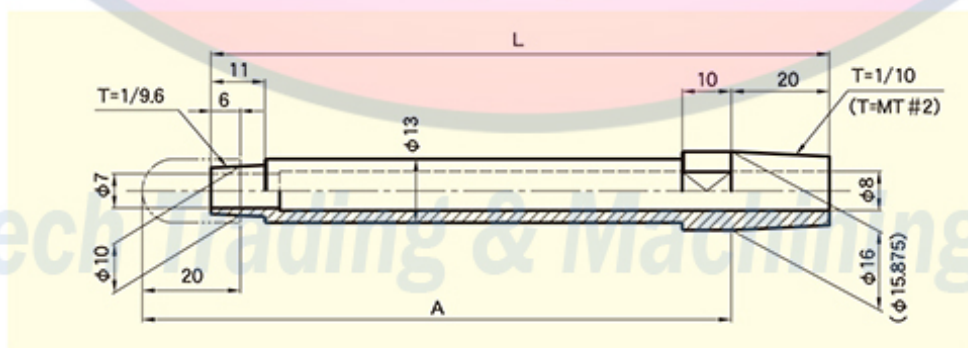

Mastech Trading & Machining co., Ltd.

Stepped Shank 段付シャンク

Shank

キャップチップ取り外し付シャンク

with nut for removing Cap-Tip-NATUME

Utility model pending



Cap Tip is possible to be removed by lightly turning a hexagonal Nut with a spanner. In addition, no damages will be caused at taper on shank that makes shank's durability to be dramatically improved. Please feel safe to use low cost Cap Tip.

キャップチップの取り外しは六角ナットを廻すだけです。素早く、簡単に取り外しが出来ます。

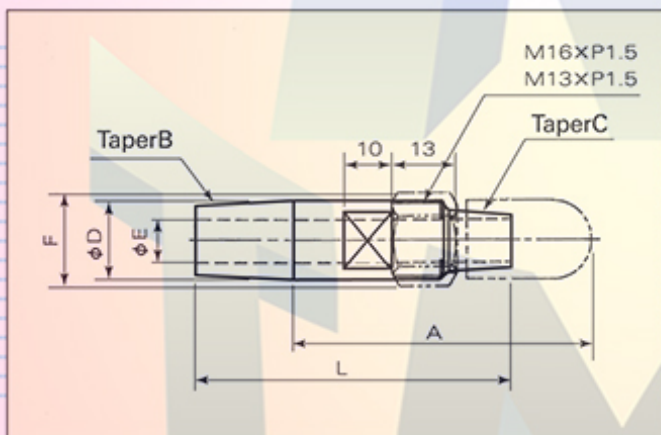

material(材質) : BeA-25

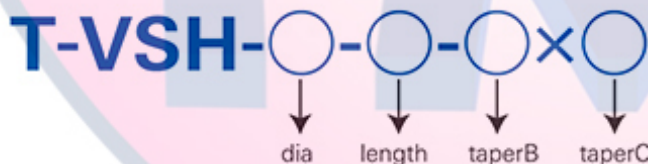

There are following five or three types of tapers. Please select your required taper from following list and write them in circles of B and C tapers.

Unit(単位):mm

Model No.	L	A	D	E	F	G
T-VSH-16- 50-○×○	54	50	16	9	19	17
T-VSH-16- 60-○×○	64	60	16	9	19	17
T-VSH-16- 80-○×○	84	80	16	9	19	17
T-VSH-16-100-○×○	104	100	16	9	19	17
T-VSH-13- 50-○×○	52	50	13	7	16	14
T-VSH-13- 60-○×○	62	60	13	7	16	14
T-VSH-13- 80-○×○	82	80	13	7	16	14
T-VSH-13-100-○×○	102	100	13	7	16	14

No.	Taper B	Taper C
1	φ12×1/10	φ10×1/9.6
2	φ12.065×MT#1	φ10×1/10
3	φ16×1/10	φ12.6×1/9.6
4	φ15.875×MT#2	φ12.6×1/10
5	φ16×1/5	

Offset Shank (1/10 taper type)

曲がりシャंक(1/10テーパー・クローム銅)



$\phi 16$

T=1/10

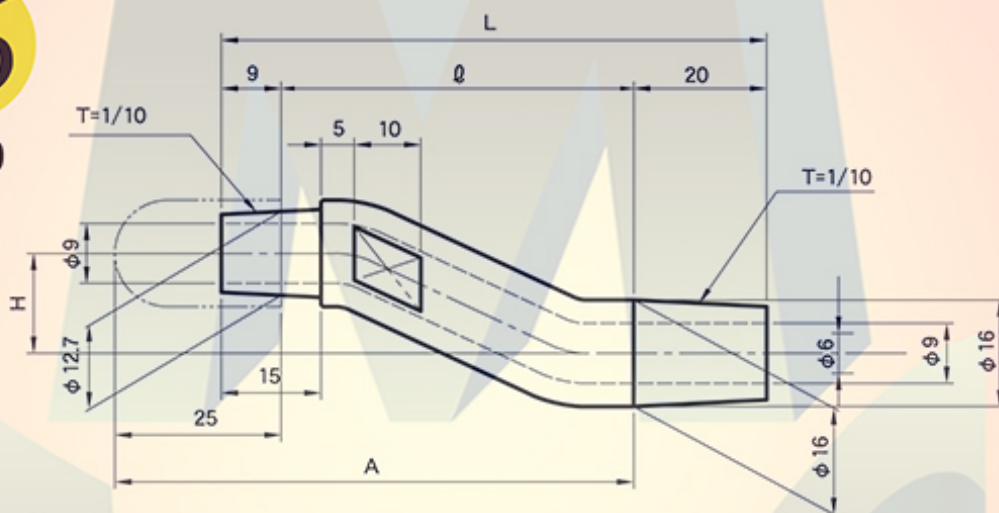

Unit(単位):mm

Model No. 型式	Length L 全長	Offset H 芯間	Effective length A 有効長	ϕ
N-SH-16-55-5	55	5	51	26
N-SH-16-65-5	65	5	61	36
N-SH-16-75-5	75	5	71	46
N-SH-16-55-10	55	10	51	26
N-SH-16-65-10	65	10	61	36
N-SH-16-75-10	75	10	71	46
N-SH-16-60-15	60	15	56	31
N-SH-16-65-15	65	15	61	36
N-SH-16-70-15	70	15	66	41
N-SH-16-75-15	75	15	71	46
N-SH-16-80-15	80	15	76	51
N-SH-16-85-15	85	15	81	56
N-SH-16-90-15	90	15	86	61
N-SH-16-95-15	95	15	91	66
N-SH-16-100-15	100	15	96	71

material(材質): CrCu(クローム銅)

Please order with the model number below.

ご注文は下記の記号にてお願いいたします。

N-SH-16-**-**

Length 全長 L

Offset size 偏芯高さ H

Electrode for Spot Welder

Offset Shank (φ15.875×MT#2Taper)

曲がりシャック



φ15.875
T=MT#2

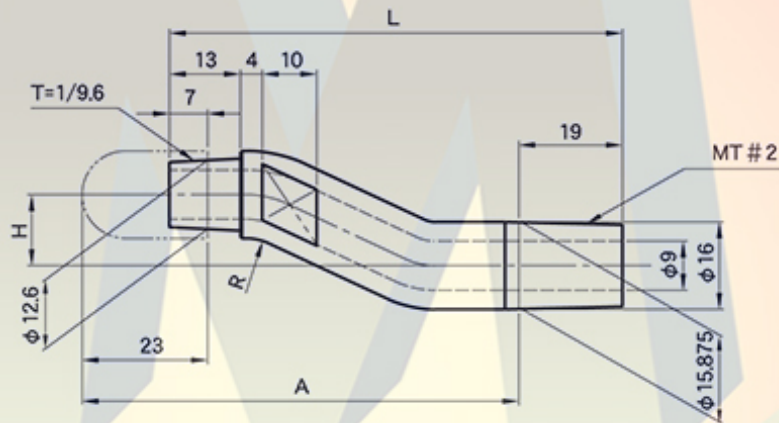

Unit(単位):mm

Model No. 型式	Off set H 芯間	Effective length A 有効長	Length L 全長
W-SH-16-50-3	3	50	53
W-SH-16-60-3	3	60	63
W-SH-16-50-6	6	50	53
W-SH-16-60-6	6	60	63
W-SH-16-80-6	6	80	83
W-SH-16-50-9	9	50	53
W-SH-16-60-9	9	60	63
W-SH-16-80-9	9	80	83
W-SH-16-50-13	13	50	53
W-SH-16-60-13	13	60	63
W-SH-16-80-13	13	80	83
W-SH-16-60-15	15	60	63
W-SH-16-80-15	15	80	83
W-SH-16-60-19	19	60	63
W-SH-16-80-19	19	80	83
W-SH-16-100-19	19	100	103

material(材質): BeA-25

Please order with the model number below.
ご注文は下記の記号にてお願いいたします。

W-SH-16--

Effective length 有効長A

Eccentric length 偏芯量H

Mastech Trading Co., Ltd. Machining co., Ltd.

Bent Arm for Cap Tip (90° type)

丸アーム (クローム銅・90°タイプ)

φ **13**

CapTip

φ13キャップチップ

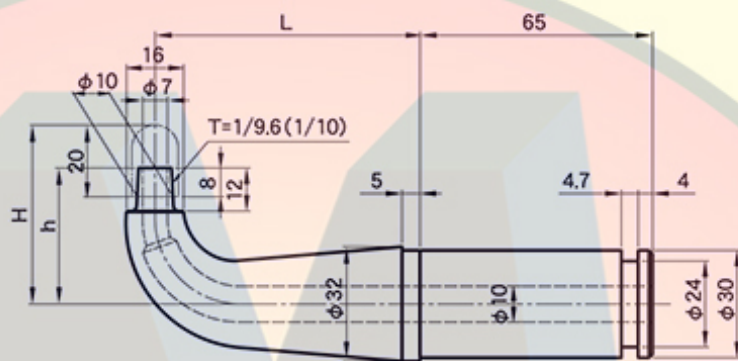

Unit(単位):mm

Model No. 型式	H	h	L
SH-13-45-74	45	33	74
SH-13-45-114	45	33	114
SH-13-50-74	50	38	74
SH-13-50-114	50	38	114
SH-13-55-74	55	43	74
SH-13-55-114	55	43	114
SH-13-60-74	60	48	74
SH-13-60-114	60	48	114

material(材質): CrCu(クローム銅)

φ **16**

CapTip

φ16キャップチップ

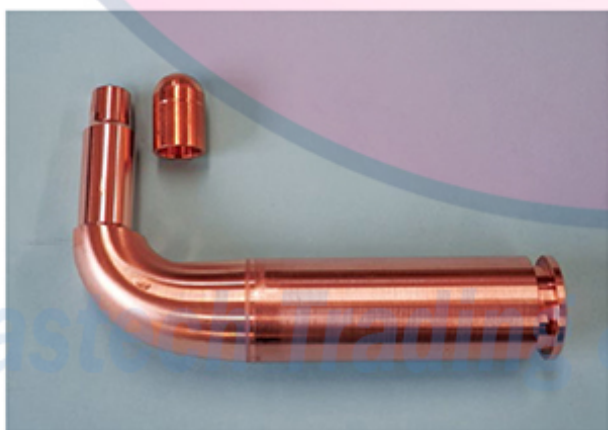
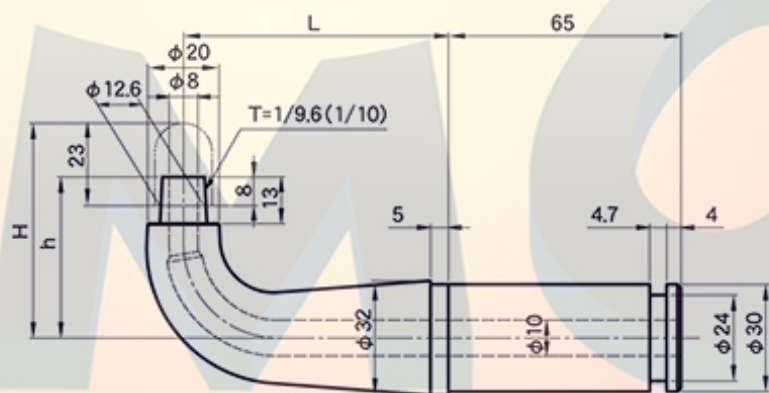

Unit(単位):mm

Model No. 型式	H	h	L
SH-16-45-74	45	30	74
SH-16-45-114	45	30	114
SH-16-50-74	50	35	74
SH-16-50-114	50	35	114
SH-16-55-74	55	40	74
SH-16-55-114	55	40	114
SH-16-60-74	60	45	74
SH-16-60-114	60	45	114

material(材質): CrCu(クローム銅)

Bent Arm for Cap Tip(15° type)

丸アーム(クローム銅・15°タイプ)

φ 13

CapTip

φ 13キャップチップ

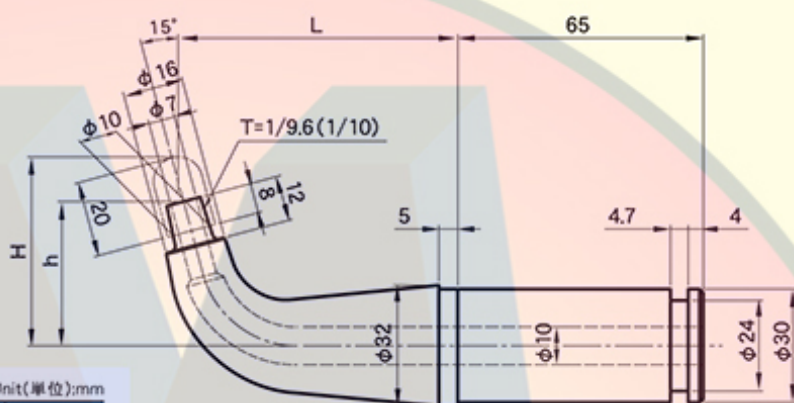

Unit(単位):mm

Model No. 型式	H	h	L
SHQ-13-45-74	45	33.2	74
SHQ-13-45-114	45	33.2	114
SHQ-13-50-74	50	38.2	74
SHQ-13-50-114	50	38.2	114
SHQ-13-55-74	55	43.2	74
SHQ-13-55-114	55	43.2	114
SHQ-13-60-74	60	48.2	74
SHQ-13-60-114	60	48.2	114

material(材質): CrCu(クローム銅)



φ 16

CapTip

φ 16キャップチップ

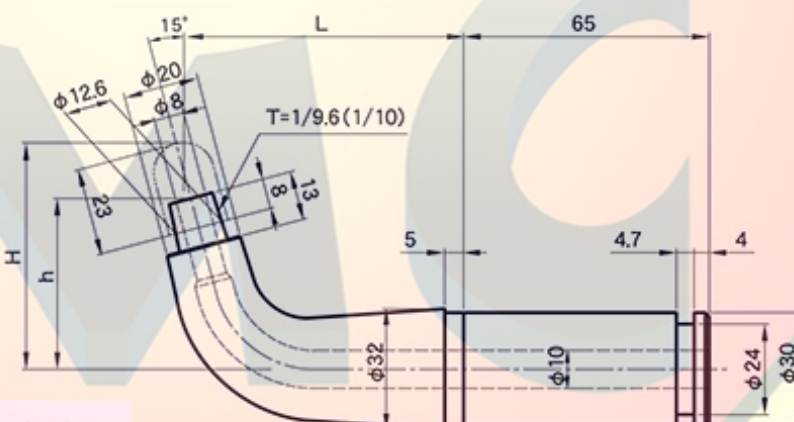

Unit(単位):mm

Model No. 型式	H	h	L
SHQ-16-45-74	45	30.2	74
SHQ-16-45-114	45	30.2	114
SHQ-16-50-74	50	35.2	74
SHQ-16-50-114	50	35.2	114
SHQ-16-55-74	55	40.2	74
SHQ-16-55-114	55	40.2	114
SHQ-16-60-74	60	45.2	74
SHQ-16-60-114	60	45.2	114

material(材質): CrCu(クローム銅)

